



Designed and Manufactured by/Conception et Fabrication par/Diseño y fabricado por
ECOVACS ROBOTICS, Co., Ltd
MADE IN CHINA/FAIT EN CHINE/HECHO EN CHINA
Distributed by/Distribué par/Distribuido por
ECOVACS ROBOTICS, Inc.
Canton, OH, USA/Canton, OH, É.-U.
www.ecovacs.com

DEEBOT 3-018-IM2014R03

DEEBOT 3

EN

Instruction Manual



Live Smart. Enjoy Life.

Congratulations on the purchase of your ECOVACS ROBOTICS DEEBOT! We hope it brings you many years of satisfaction. We trust the purchase of your new robot will help keep your home clean and provide you with more quality time to do other things.

Before you go any further, please register your product on the ECOVACS ROBOTICS website at www.ecovacsrobotics.com/registration/. We also suggest you record your model number, serial number, date of purchase and attach your receipt to this page for safekeeping.

MODEL # _____

SERIAL # _____

DATE OF PURCHASE ____/____/____

Should you have any problems programming the robot or getting your robot to function properly, please call us before contacting or returning it to the place of purchase. Call toll free number 1-844-ECOVACS (1-844-326-8227) or 1-330-994-1760 from outside the United States of America and Canada for assistance.

Thank you for choosing DEEBOT!

Contents

- 1. Important Safety Instructions2
- 2. Package Contents and Technical Specifications.....4
 - 2.1 Package Contents4
 - 2.2 Technical Specifications.....4
 - 2.3 Product Diagram.....5
- 3. Operating and Programming6
 - 3.1 Notes Before Cleaning6
 - 3.2 Quick Start.....7
 - 3.3 Intelligent Scheduling.....8
- 4. Maintenance.....10
 - 4.1 Dust Bin and Filters10
 - 4.2 Suction Intake and Side Brushes10
 - 4.3 Other Components11
- 5. Troubleshooting.....12

1. Important Safety Instructions

When using an electrical appliance, basic precautions should always be followed, including the following:

READ ALL INSTRUCTIONS BEFORE USING THIS APPLIANCE.

SAVE THESE INSTRUCTIONS

1. This Appliance is not intended to be used by children under 8 or anyone lacking knowledge on proper use. Supervision may be necessary. Do not allow children to sit on or play with the Appliance.
2. Clear the area to be cleaned. Remove power cords and small objects from the floor that could entangle the Appliance. Tuck rug fringe under the rug base, and lift items such as curtains and tablecloths off the floor.
3. If there is a drop off in the cleaning area due to a step or stairs, you should operate the Appliance to ensure that it can detect the step without falling over the edge. It may become necessary to place a physical barrier at the edge to keep the unit from falling. Make sure the physical barrier is not a trip hazard.
4. Only use as described in this manual. Only use attachments recommended or sold by the manufacturer.
5. Please make sure your power supply voltage matches the power voltage marked on the Charging Dock.
6. For INDOOR household use ONLY. Do not use the Appliance in outdoor, commercial or industrial environments.
7. Use only the original rechargeable battery and Charging Dock provided with the Appliance from the manufacturer. Non-rechargeable batteries are prohibited. For battery information, please refer to Specifications section.
8. Do not use without dust bin and/or filters in place.
9. Do not operate the Appliance in an area where there are lit candles or fragile objects.
10. Do not use in extremely hot or cold environments (below $-5^{\circ}\text{C}/23^{\circ}\text{F}$ or above $40^{\circ}\text{C}/104^{\circ}\text{F}$).
11. Keep hair, loose clothing, fingers, and all parts of body away from any openings and moving parts.
12. Do not operate the Appliance in a room where an infant or child is sleeping.
13. Do not use Appliance on wet surfaces or surfaces with standing water.
14. Do not allow the Appliance to pick up large objects like stones, large pieces of paper or any item that may clog the Appliance.
15. Do not use Appliance to pick up flammable or combustible materials such as gasoline, printer or copier toner, or use in areas where they may be present.
16. Do not use Appliance to pick up anything that is burning or smoking, such as cigarettes, matches, hot ashes, or anything that could cause a fire.
17. Do not put objects into the suction intake. Do not use if the suction intake is blocked. Keep the intake clear of dust, lint, hair, or anything that may reduce air flow.
18. Take care not to damage the power cord. Do not pull on or carry the Appliance or Charging Dock by the power cord, use the power cord as a handle, close a door on the power cord, or pull power cord around sharp edges or corners. Do not run Appliance over the power cord. Keep power cord away from hot surfaces.
19. If the power cord is damaged, it must be replaced by the manufacturer or its service agent in order to avoid a hazard.
20. Do not use the Charging Dock if it is damaged.
21. Do not use with a damaged power cord or receptacle. Do not use the Appliance or Charging Dock if it is not working properly, has been dropped, damaged, left outdoors, or come in contact with water. It must be repaired by the manufacturer or its service agent in order to avoid a hazard.

1. Important Safety Instructions

22. Turn OFF the power switch before cleaning or maintaining the Appliance.
23. The plug must be removed from the receptacle before cleaning or maintaining the Charging Dock.
24. Remove the Appliance from the Charging Dock, and turn OFF the power switch to the Appliance before removing the battery for disposal of the Appliance.
25. The battery must be removed and discarded according to local laws and regulations before disposal of the Appliance.
26. Please dispose of used batteries according to local laws and regulations.
27. Do not incinerate the Appliance even if it is severely damaged. The batteries can explode in a fire.
28. When not using the Charging Dock for a long period of time, please unplug it.
29. The Appliance must be used in accordance with the directions in this Instruction Manual. ECOVACS ROBOTICS cannot be held liable or responsible for any damages or injuries caused by improper use.

2. Package Contents and Technical Specifications

2.1 Package Contents

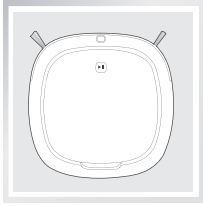

Robot

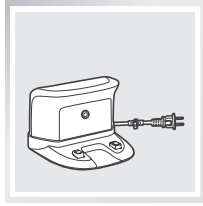

Charging Dock



Instruction Manual

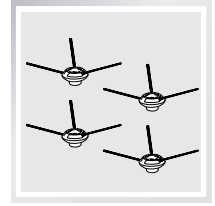

(4) Side Brushes

2.2 Technical Specifications

Model	D35		
Working Voltage	12V DC	Rated Power	15W
Charging Dock Model	CH1426B		
Rated Input Voltage	120V AC	Rated Output Voltage	14.5V DC
Rated Output Current	0.75A	Rated Power	20W
Battery	Ni-MH SC 1800mAh		

* Technical and design specifications may be changed in the course of continuous product improvement.

2. Package Contents and Technical Specifications

2.3 Product Diagram

Robot

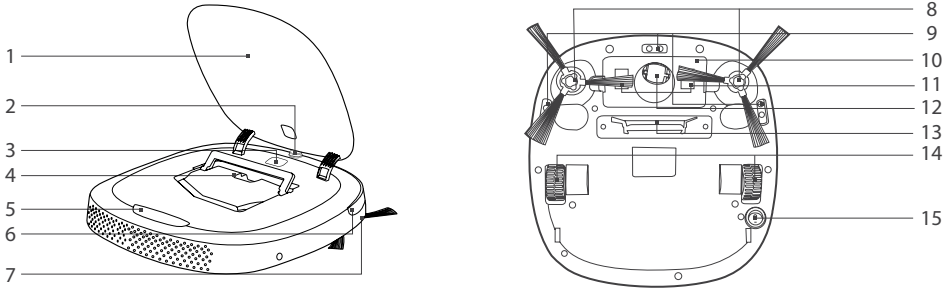

- | | | |
|-----------------------------------------|---------------------------|-------------------------|
| 1. Top Cover | 6. Anti-Collision Sensors | 11. Charging Contacts |
| 2. Infrared Receiver for Remote Control | 7. Bumper Strip | 12. Universal Wheel |
| 3. Start/Pause Button | 8. Anti-Drop Sensors | 13. Suction Intake |
| 4. Dust Bin | 9. Side Brushes | 14. Driving Wheels |
| 5. Indicator Light | 10. Battery Pack | 15. Bottom Power Switch |

Charging Dock

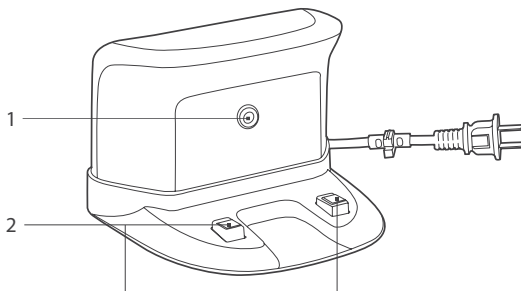

- | |
|------------------------------|
| 1. Infrared Signal Generator |
| 2. Charging Dock Pins |

Dust Bin

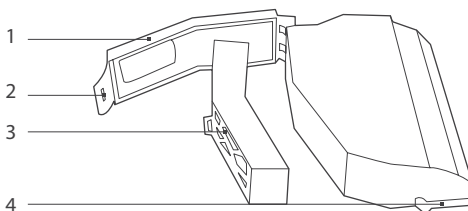

- | |
|---------------------------|
| 1. Dust Bin Cover |
| 2. Dust Bin Cover Lock |
| 3. High Efficiency Filter |
| 4. Dust Bin Handle |

3. Operating and Programming

3.1 Notes before Cleaning

Before Operating DEEBOT, take a few moments to survey the area to be cleaned and remove any obstacles.

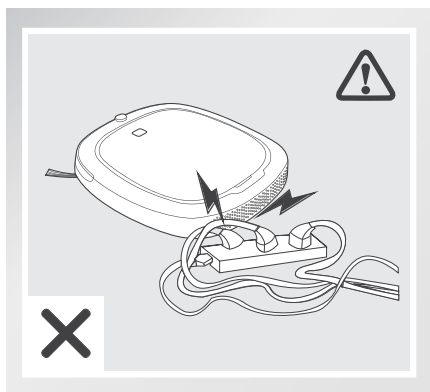

Remove power cords and small objects from the floor that could entangle the product.

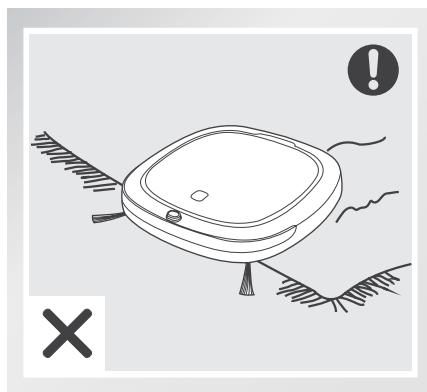

The product is not suitable for use on carpet. Before using the product near an area rug, please fold area rug edges under themselves.

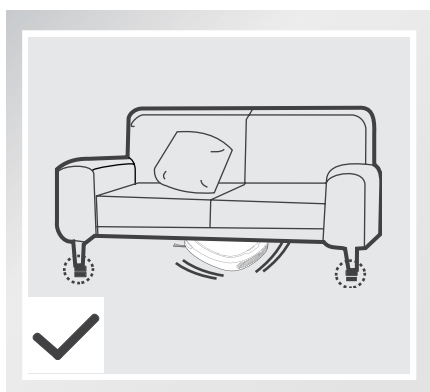

Please be aware that the robot needs at least a 6 cm (2.4") clearance to clean under furniture without complications.

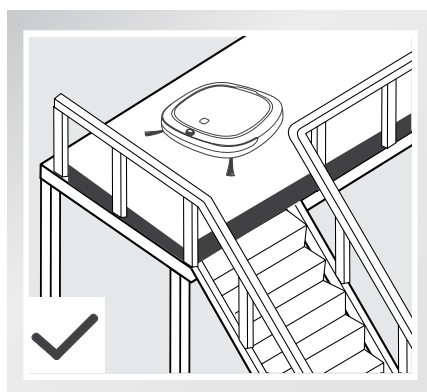

If there is a step or stairs in the cleaning area, please operate DEEBOT 3 to ensure its Anti-Drop Sensors can detect the drop off. It may be necessary to place a physical barrier at the edge of the drop off to keep the unit from falling over the edge.

3. Operating and Programming

3.2 Quick Start

1 Charging Dock Placement

- Place the Charging Dock on a level floor surface against the wall with the base perpendicular to the ground. Keep the immediate area 1.5m (5') in front of the charger and 0.5m (1.6') on both sides of the charger clear of objects and reflective surfaces.
- Plug the Charging Dock in.

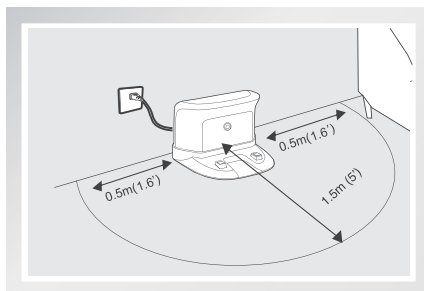

2 Install Side Brushes

- Attach Side Brushes to the bottom of DEEBOT 3 by pressing a brush into each slot until it clicks.

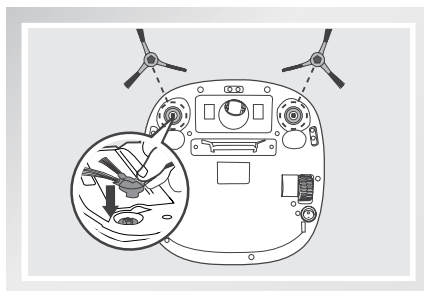

3 Power ON

- Turn the robot's Bottom Power Switch to the ON position. "I" indicates ON and "O" indicates OFF.

* When DEEBOT 3 is not working, it is suggested to keep it powered ON and charging instead of powered OFF.

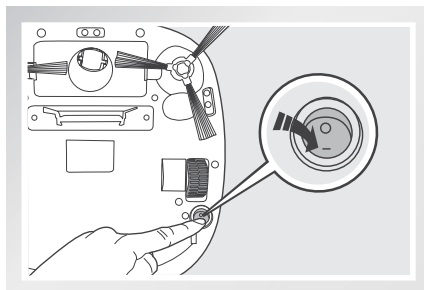

4 Charge DEEBOT 3

- Place DEEBOT 3 on the Charging Dock making sure the Charging Contacts on DEEBOT 3 and the Charging Dock Pins make a connection.
- Charge DEEBOT 3 for at least 12 hours before the first use.

* Indicator Light blinks RED, BLUE and GREEN when DEEBOT 3 is charging and glows a continuous GREEN when fully charged.

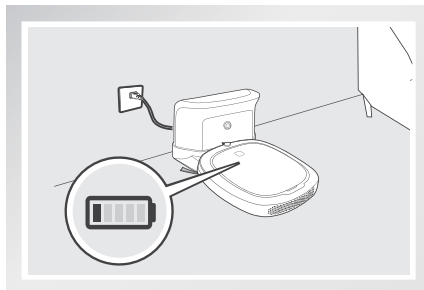

3. Operating and Programming

5 Start

- Press  on DEEBOT 3 and the robot starts to work immediately.

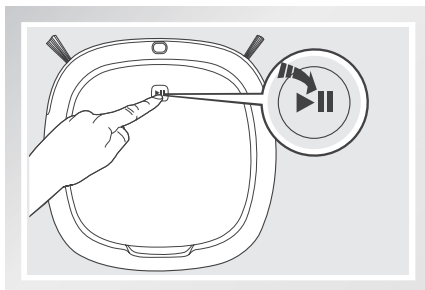

6 Pause

- Pause DEEBOT 3 by pressing  .

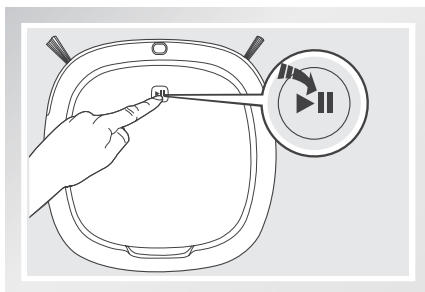

3.3 Intelligent Scheduling

DEEBOT 3 has an Intelligent Scheduling function. DEEBOT 3 can be scheduled to clean once per day at the same time, even if nobody is at home.

1 Set Intelligent Scheduling

Press and hold the Start/Pause Button  on DEEBOT 3 for 3 seconds to set the current time as the scheduled cleaning time. Intelligent Scheduling is set successfully when DEEBOT 3 beeps and the Indicator Light glows a continuous BLUE.

For example: Set Intelligent Scheduling successfully at 9:00am, and DEEBOT 3 automatically cleans at 9:00am every day.

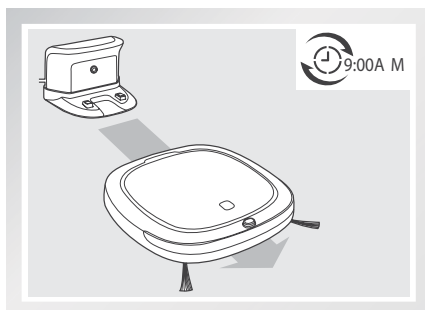
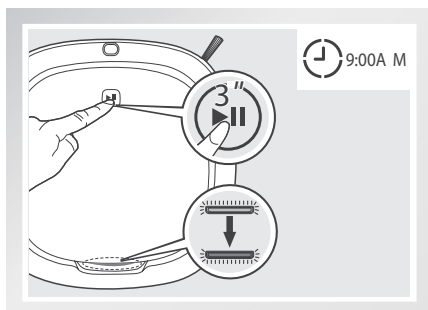

3. Operating and Programming

2 Cancel Intelligent Scheduling

Press and hold the Start/Pause Button ►|| on DEEBOT 3 for 3 seconds again. Intelligent Scheduling is cancelled when DEEBOT 3 beeps and the Indicator Light changes to a continuous GREEN.

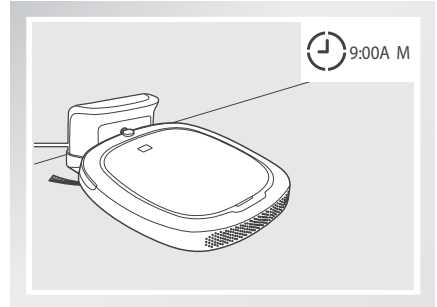
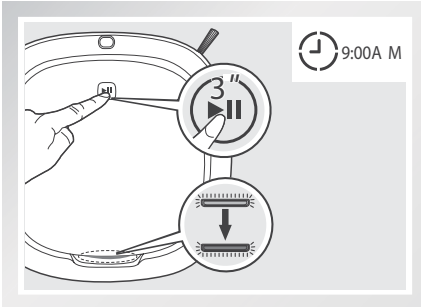

- * To automatically clean at another time, first cancel the current Intelligent Scheduling, then set Intelligent Scheduling again at the desired time.
- * If DEEBOT 3 is turned OFF, Intelligent Scheduling is cancelled.

4. Maintenance

* Before performing cleaning and maintenance, turn DEEBOT 3's Bottom Power Switch to the OFF position and unplug the Charging Dock.

4.1 Dust Bin and Filters

- 1 Open DEEBOT 3's Top Cover and remove the Dust Bin. Open the Dust Bin Cover and empty the Dust Bin.

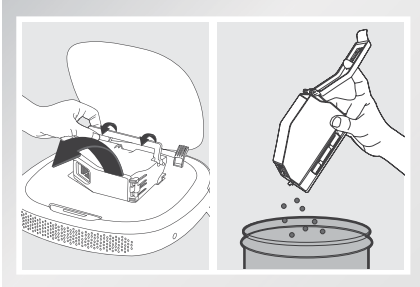

- 3 Rinse the Dust Bin under running water.

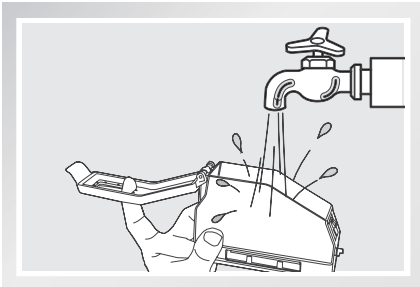

- 2 Remove the filter. Pat the High Efficiency Filter clean. Do not rinse the High Efficiency Filter under water.

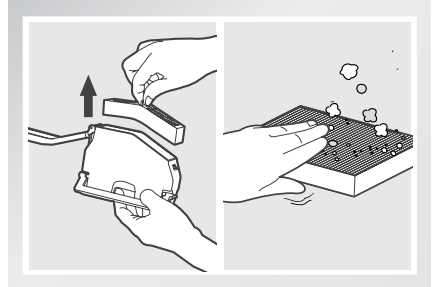

- 4 Dry the Dust Bin completely before reinstalling.

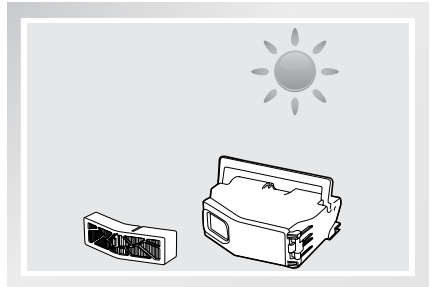

4.2 Suction Intake and Side Brushes

Wipe the Suction Intake with a dry cloth.

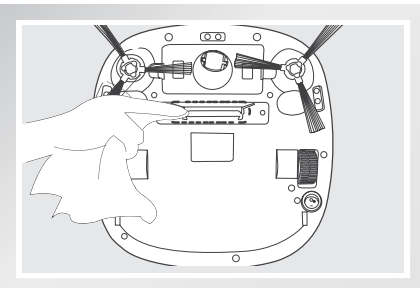

Remove the Side Brushes. Wipe the Side Brushes and their slots clean with a dry cloth.

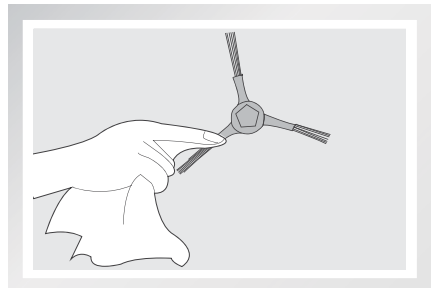

4. Maintenance

4.3 Other Components

Clean the Universal Wheel by removing any hair tangled around it.

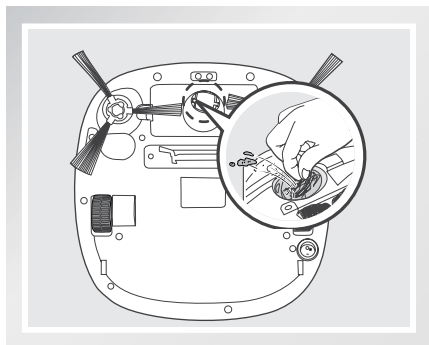

Wipe the Anti-Drop Sensors with a dry cloth to maintain their effectiveness.

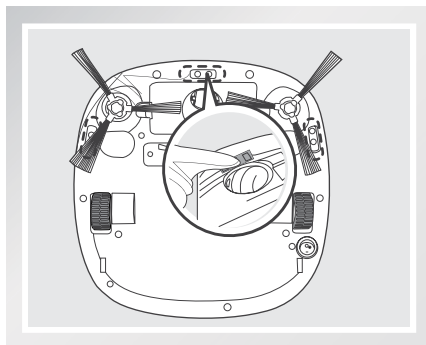

Wipe the Charging Contacts and Charging Dock Pins clean with a dry cloth.

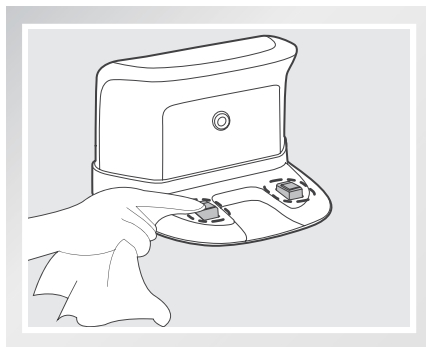
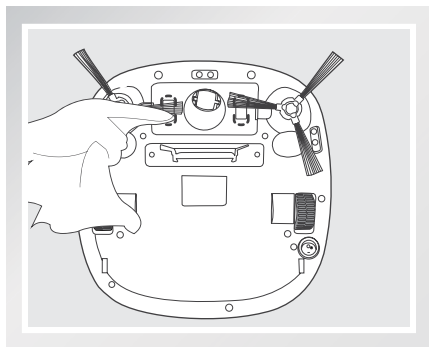

- * Remove DEEBOT 3's battery if the robot will not be used for a long time. In case of battery leakage, please remove the battery and wipe the battery slot clean while wearing protective gloves.
- * If DEEBOT 3's battery is fully discharged or not used for a long time, its capacity may decrease, and need to be reactivated.
- * To reactivate the battery: Place the robot on the Charging Dock by hand, remove after charging for 3 minutes; repeat 3 times, then charge normally for 3-5 hours.
- * DEEBOT 3 uses a long life Ni-MH battery, and does not require frequent replacement. To replace the battery, contact Customer Service or follow the below instructions:
 - a. Push the tabs on both sides of the Battery Pack to remove the Battery Pack.
 - b. Insert new Battery Pack and press until it's fully locked in place.

5. Troubleshooting

Please use this chart to troubleshoot common problems using DEEBOT 3.

No.	Malfunction	Possible Causes	Solutions
1	DEEBOT 3 will not charge.	DEEBOT 3's Bottom Power Switch is not turned ON.	Turn DEEBOT 3's Bottom Power Switch to the ON position.
		DEEBOT 3 has not made a connection with the Charging Dock.	Be sure that DEEBOT 3 has made a connection with the Charging Dock Pins. You may move the robot manually to make the connection if necessary.
		Charging Dock is unplugged while DEEBOT 3's Bottom Power Switch is ON, which causes battery consumption.	Plug in the Charging Dock and ensure DEEBOT 3's Bottom Power Switch is turned ON. Keep DEEBOT 3 on the Charging Dock to make sure it has full a battery to work at any time.
		The battery is completely discharged.	Re-activate the battery. Place DEEBOT 3 on the Charging Dock by hand, remove after charging for 3 minutes, repeat 3 times; then charge normally.
2	DEEBOT 3 gets into trouble while working and stops.	DEEBOT 3 is tangled with something on the floor (electrical cords, drooping curtains, area rug fringe etc.).	DEEBOT 3 will try various ways to get itself out of trouble. If it is unsuccessful, manually remove the obstacles and restart.
3	DEEBOT 3 returns to the Charging Dock before it finishes cleaning.	When battery power gets low, DEEBOT 3 automatically switches to Return to Charger Mode and returns to the Charging Dock to recharge itself.	This is normal. No solution necessary.
		Working time varies according to floor surface and room complexity.	This is normal. No solution necessary.
4	DEEBOT 3 will not clean automatically at scheduled time.	Intelligent Scheduling function is cancelled.	Please refer to section 3.3 Intelligent Scheduling for details.
		DEEBOT 3's Bottom Power Switch is turned OFF.	Turn DEEBOT 3's Bottom Power Switch to the ON position.
		DEEBOT 3's battery is low.	Keep DEEBOT 3 powered ON and on the Charging Dock to make sure it has a full battery to work at any time.
		DEEBOT 3's Suction Intake is blocked and/or its components are tangled with obstacles.	Turn DEEBOT 3's power OFF, clean the Dust Bin, and invert the robot. Clean the Suction Intake and components of DEEBOT 3 as described in section 4.3.